



- ◆ Fits ARC's IES™ Enclosure Solutions
—SOLD SEPARATELY (ARC-IE1001K99 excluded)
- ◆ High Port to Port Isolation for Ideal MIMO performance
- ◆ US Engineered
- ◆ Manufactured under strict US quality control procedures
- ◆ Low profile and rugged design for outdoor use
- ◆ Custom Enclosures available

ARC-ID5823B88

Electrical Specifications	
Frequency Range	4.94—5.875 GHz
Gain (Typ)	24dBi Vertical 23dBi Horizontal
3dB Beamwidth Vertical/Horizontal	8 degrees/8 degrees
ETSI	ETSI 2, 3, and 5
VSWR 4.94-4.99GHz 5.15-5.875GHz	≤1.5:1 typ., ≤1.9:1 max ≤1.5:1 typ., ≤1.7:1 max.
Port to Port Isolation	40dB (minimum)
Front-to-Back Ratio	>40 dBi
Cross Polarization	>30 dBi
Sidelobe Level	>12 dBi
Power Rating	30 watts
Impedance	50 ohms
Lightning Protection	DC ground

Ordering Information	
Part #	Description
ARC-ID5823B88	5.8GHz 24/23dBi Dual Pol, R/A SMA Jack

Shipping Information	
Sizes and Weights	Description
19in x 16in x 16in (48.6cm x 40.6cm x 40.6cm) 44 lbs (19.95 kg)	Bulk Pack, includes 5 in an over pack box



Mechanical and Environmental Specifications	
Length x Width x Depth	15.2in x 15.2in x 1.12in (38.6cm x 38.6cm x 2.8cm)
Weight	3.6lbs (1.66kg)
Backplane	Aluminum
Radome	UV stabilized ABS plastic, gray
Wind Survivability	125mph (201kph)
Wind Load	1.6ft ² (0.148m ²)
Operating Temperature Range	-49°F to 149°F (-45°C to 65°C)
Pole Mount Diameter Range	See ARC IES™ Enclosure Solutions
Environmental	IP 67 (with Enclosure)
Connector (2)	R/A SMA Jack

Vertical Polarization

RF Patterns
Vertical Cut, typ.

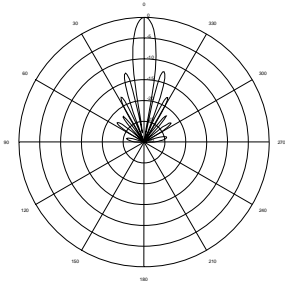

RF Patterns
Horizontal Cut, typ.

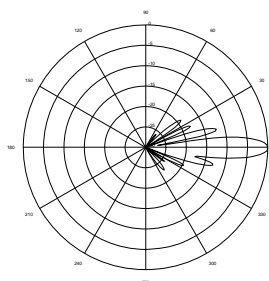

Horizontal Polarization

RF Patterns
Vertical Cut, typ.

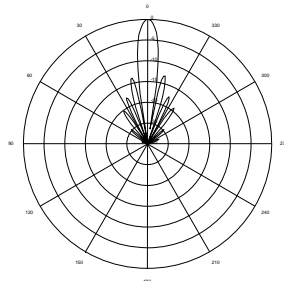

RF Patterns
Horizontal Cut, typ.

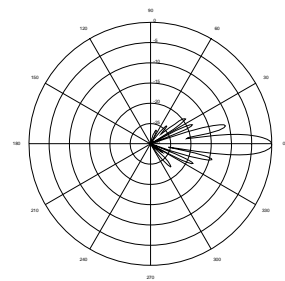

Generation II Enclosure for ARC IES™ Integrated Enclosure Solution with patent pending Universal Mounting Feature



- **ARC IES™** is a complete enclosure solution that includes the **ARC ABS™** bracket
- Quick installation with **RIT, Radio Installation Tool** - directly compatible with multiple radios - contact ARC for more details
- Numerous antenna options available (see below—sold separately)

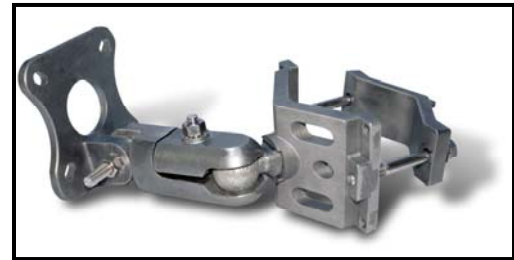

Enclosure Specs	
Outer Dimensions Length x Width x Depth	8.6in x 8.6in x 3.17in (218mm x 218mm x 81mm)
Inner Dimensions Length x Width x Depth	7.47in x 7.47in x 2.5in (190mm x 190mm x 64mm)
Exterior Coating	Powder coated, die cast aluminum, light gray, textured
Wind Survivability	125mph (201kph)
Operating Temperature Range	-40 to 185 °F (-40 to +85 °C)
Enclosure Part Number	ARC-IE2000K01

ARC ABS™, Articulating Bracket Solution Specs	
Length x Width x Depth	10.59in x 4.17in x 3.54 in (269mm x 106mm x 90 mm)
Weight	2.0lb (.91 kg)
Material	Die-cast Aluminum with zinc plated steel bolts
Pole Mount Diameter Range	1.0in to 3.0in (25.4mm to 76.2mm)
Bracket Part Number	ARC-BR0701S01 (included when ordering Gen II)

Compatible Radios:		
ADI	MikroTik	RTL
Pronghorn	RB 112	8186
	RB 133	
Gateworks	RB 133c	Ubiquiti
2342	RB 133c w/SR9	LS2
2347	RB 411	LS5
2348	RB 500	
	RB 532	Zinwell
PC Engines		ZW2200
Wrap 1C		ZW2200 w/Jumper
Wrap 2B		ZW2120

If you have a specific radio not shown here, please contact ARC to see if it will fit with the Gen II Enclosure.

Antenna Options:
900MHz
2.4GHz
2.5GHz
3.5GHz
4.9GHz
5.8GHz
Dual Pols

Check www.antennas.com for new antenna releases.